

Fogo Island's Age-Friendly Recreational Area

Final Concept Package

October 2023



Introduction

Currently being used as a soccer field, the Town would like to re-imagine the space adjacent to the Iceberg Arena as a multi-sport recreation area and open space. Due to its proximity to the school and the arena, this space offers an excellent opportunity to introduce new attractions such as multi-purpose courts including basketball and tennis, long jump, running tracks, seating/gathering areas, and open flexible space.

Central to the re-design of this important area will be incorporating principles of age-friendly design. Newfoundland and Labrador has one of the most rapidly aging populations in Canada, so incorporating age-friendly principles will be imperative to the success of this public space for the Town of Fogo Island. It will also ensure it remains accessible and enjoyable for as many residents as possible and well into the future.



Project Goals & Objectives

The feedback collected from stakeholders directly informed the following project goals and objectives.

01

Multifunctional Spaces

- The spaces should serve more than one purpose wherever possible.
- Ensure spaces are flexible to allow different types of activities and programs to occur.
- The space will be used year-round and must include provisions for winter use, shade, shelter and lighting.

02

Evidence-Based Design

- Utilize Evidence-Based Design Principles.
- Follow regulations of Service NL (accessibility).
- Crime Prevention Through Environmental Design (safety).
- Winter City Design Principles (year-round functionality).
- Age-Friendly Design Principles.

03

Representative of Fogo Island Community

- Create a high-quality, central recreation and gathering space for the island.
- The design should represent the communities that will be using it and provide a safe space for all abilities and ages.
- The space should impart a sense of pride for the Island.

04

Expansion of School Sport Facilities

- The space should encourage sport competitions for the school.
- The space should have equipment and facilities that can facilitate competitions to bring tourism and sport to the island from surrounding communities.
- The space should continue to facilitate the school's sports and programs.

Age-Friendly Design

- Ensure a range of small intimate spaces as well as larger gathering spaces throughout the park to provide opportunities for active living and social interaction for people of all ages.
- Include elements such as benches and lighting spaced along pathways to allow for breaks. Benches should be equipped with arm rests and wheelchair accessible spaces.
- Identify locations to create or improve physical connections between neighbourhood parks and other local destinations through sidewalks, bike routes, and off-street trail connections.
- Review trail guidelines for accessibility provisions, such as width, grade, surface materials, wayfinding, and lighting.
- Continue to involve the public in planning for new parks and public spaces in the early community planning stages, and in the design phase to ensure their needs are met.
- Include consideration for the increasing use of wheelchairs, walkers, and motorized scooters in the design of sidewalks, trails, and access to buildings.
- Assess the potential to provide age-friendly features in school yards, such as benches near playgrounds and shaded areas.
- Explore separating high and low activity areas to provide different park experiences at one time.

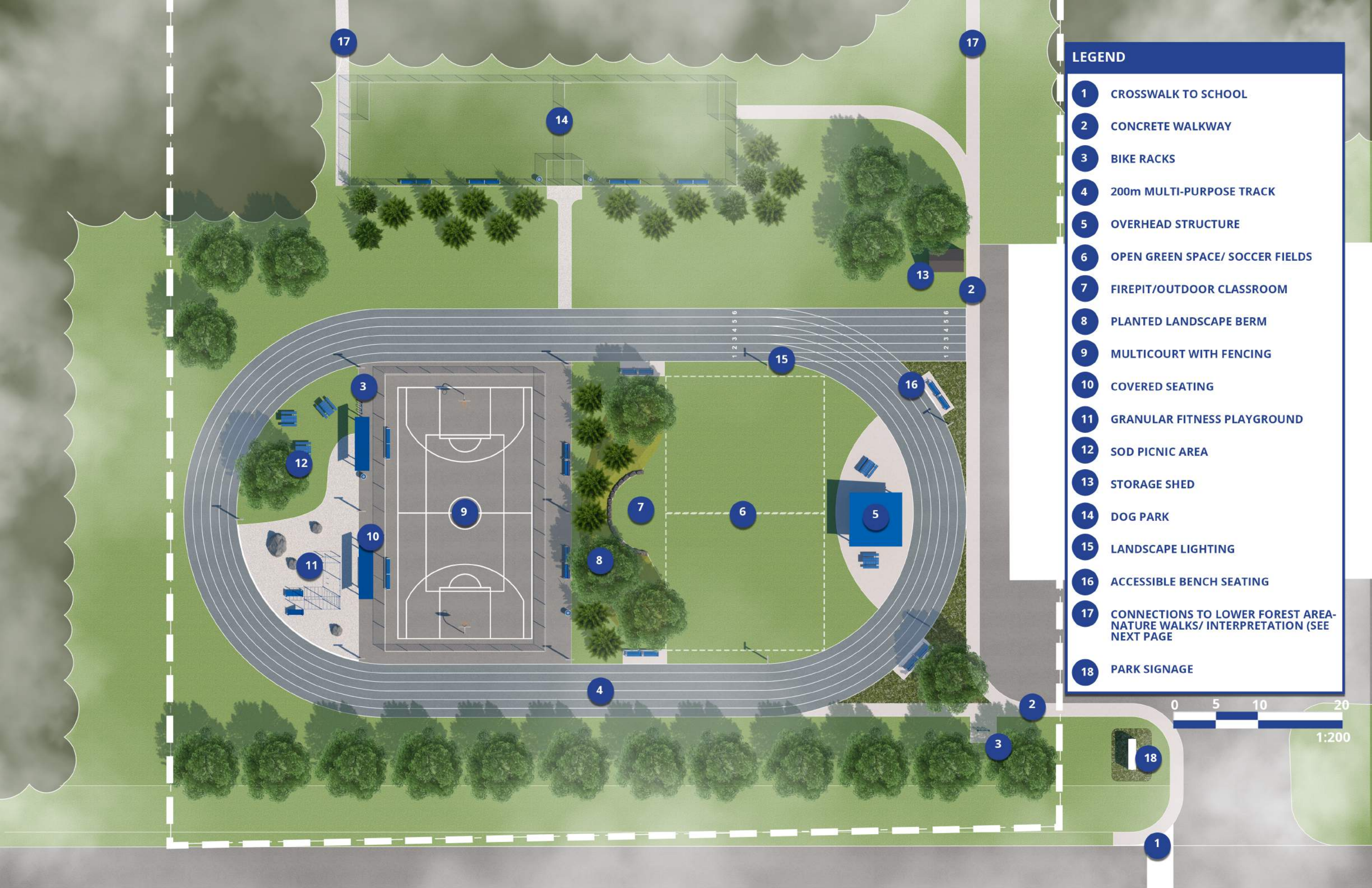

LEGEND

- 1 CROSSWALK TO SCHOOL
- 2 CONCRETE WALKWAY
- 3 BIKE RACKS
- 4 200m MULTI-PURPOSE TRACK
- 5 OVERHEAD STRUCTURE
- 6 OPEN GREEN SPACE/ SOCCER FIELDS
- 7 FIREPIT/OUTDOOR CLASSROOM
- 8 PLANTED LANDSCAPE BERM
- 9 MULTICOURT WITH FENCING
- 10 COVERED SEATING
- 11 GRANULAR FITNESS PLAYGROUND
- 12 SOD PICNIC AREA
- 13 STORAGE SHED
- 14 DOG PARK
- 15 LANDSCAPE LIGHTING
- 16 ACCESSIBLE BENCH SEATING
- 17 CONNECTIONS TO LOWER FOREST AREA- NATURE WALKS/ INTERPRETATION (SEE NEXT PAGE)
- 18 PARK SIGNAGE



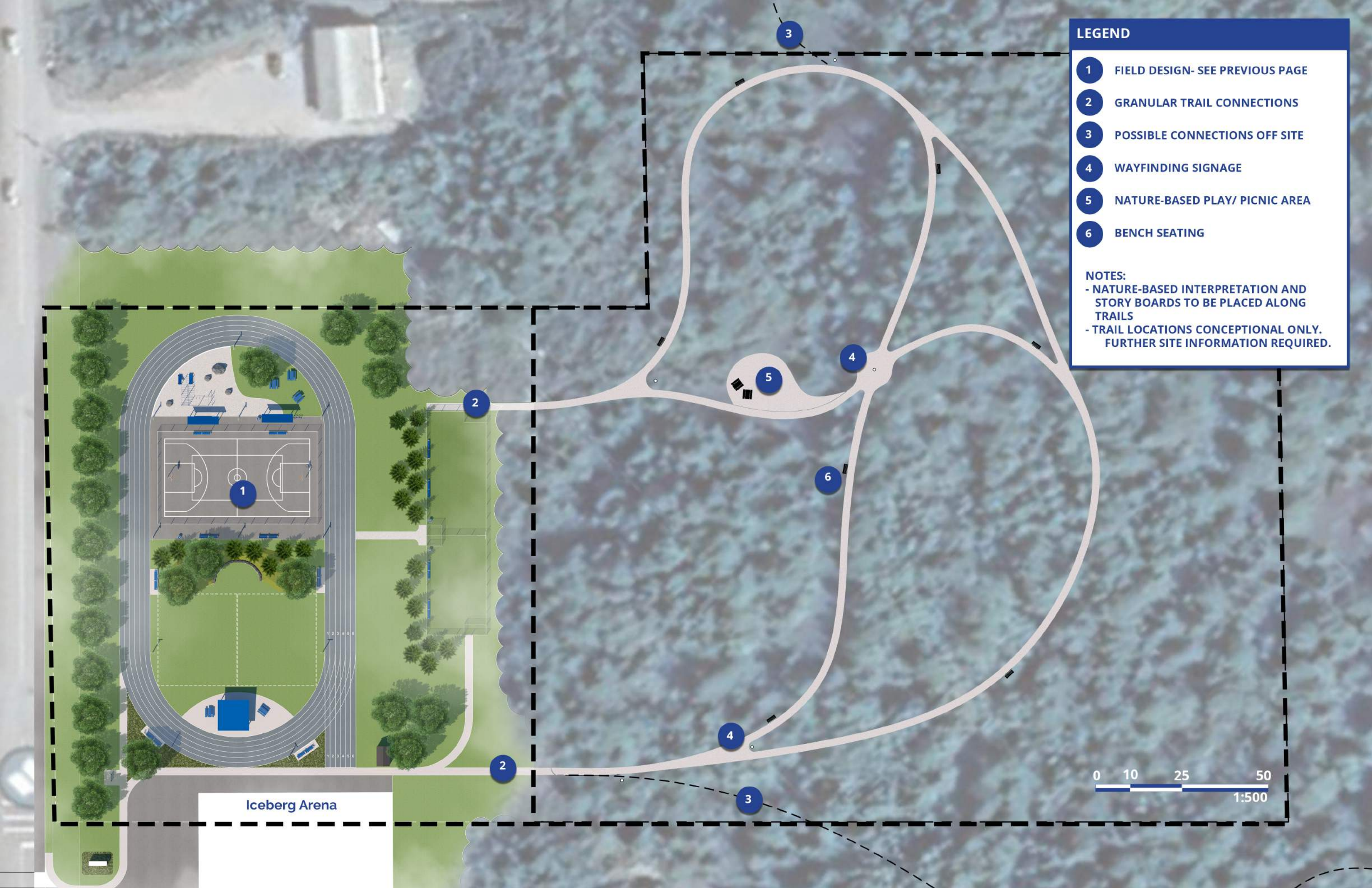

LEGEND

- 1 FIELD DESIGN- SEE PREVIOUS PAGE
- 2 GRANULAR TRAIL CONNECTIONS
- 3 POSSIBLE CONNECTIONS OFF SITE
- 4 WAYFINDING SIGNAGE
- 5 NATURE-BASED PLAY/ PICNIC AREA
- 6 BENCH SEATING

NOTES:

- NATURE-BASED INTERPRETATION AND STORY BOARDS TO BE PLACED ALONG TRAILS
- TRAIL LOCATIONS CONCEPTIONAL ONLY. FURTHER SITE INFORMATION REQUIRED.

Iceberg Arena



Precedent Images

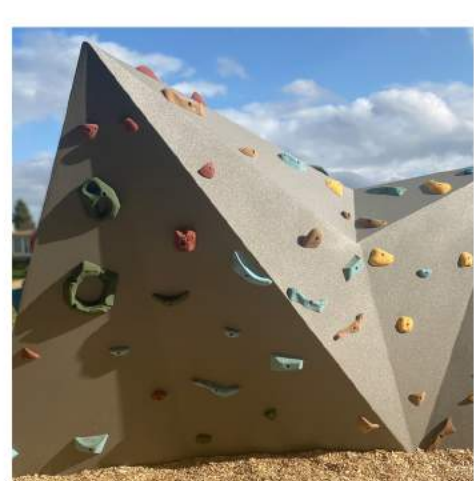
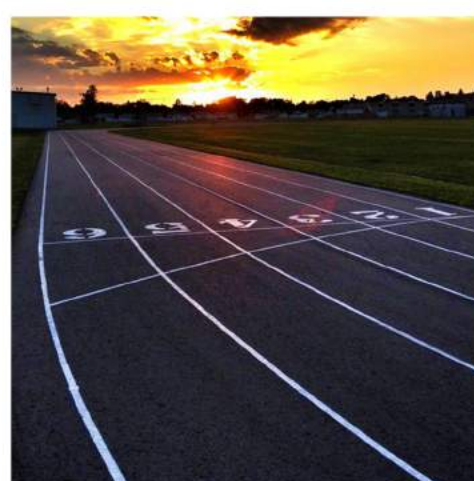

Funding Opportunities

Federal Gas Tax Fund (Infrastructure Canada)

[www.infrastructure.gc.ca/
plan/gtf-fte-eng.html](http://www.infrastructure.gc.ca/plan/gtf-fte-eng.html)

Innovative Communities Fund (ACOA)

[www.acoa-apeca.gc.ca/en
g/ImLookingFor/ProgramI
nformation/Pages/Progra
mDetails.aspx?ProgramID
=6](http://www.acoa-apeca.gc.ca/eng/ImLookingFor/ProgramInformation/Pages/ProgramDetails.aspx?ProgramID=6)

The Recreation and Sport for Persons with a Disability Funding Program (Recreation NL)

[https://recreationnl.com/
recreationnl_funding/the-
recreation-and-sport-for-
persons-with-a-disability-
funding-program/](https://recreationnl.com/recreationnl_funding/the-recreation-and-sport-for-persons-with-a-disability-funding-program/)

Active NL (Newfoundland & Labrador)

[https://www.gov.nl.ca/tca
r/funding-programs/activ
e-nl/](https://www.gov.nl.ca/tca/r/funding-programs/active-nl/)

FCC AgriSpirit Fund (FCC)

[https://www.fcc-fac.ca/en
/community/apply-fundin
g/agrispirit-fund.html](https://www.fcc-fac.ca/en/community/apply-funding/agrispirit-fund.html)

Multi-Year Capital Works Funding (Municipal Affairs & Environment)

[https://www.gov.nl.ca/ti/
mi/funding-programs/#m
ycw](https://www.gov.nl.ca/ti/mi/funding-programs/#mycw)

Community Development Grant (Jumpstart)

[https://jumpstart.canadia
ntire.ca/pages/communit
y-development-grants](https://jumpstart.canadaintire.ca/pages/community-development-grants)



Phasing Plan

Phasing allows for a project to be built over time as funding becomes available. The following is a suggested timeline for the plan provided.

01

Multi-Purpose Accessible Track

- The track defines the internal spaces of the design and should therefore be implemented first to define the zones.
- If funding is available the track and multi-court can be implemented together to reduce the costs of multiple trips for asphalt installation.
- Any footings within the asphalt such as the bench shade structures, basketball hoops, lighting and multi-court fencing should be poured before asphalt is placed.
- Ensure electrical connections for lighting made during Phase 1.

02

Multi-Court Area* Playground

- *Multi-court should be implemented in Phase 2 if it hasn't already been completed in Phase 1.
- Multi-court fencing can be installed.
- Any line painting can be painted.
- Granular fitness area with concrete curb to be installed with play equipment.

03

Concrete Walkways, Pergola & Lighting

- Shade structures, pergola and concrete walks to be installed.
- Lighting to be installed on existing bases poured during Phase 1/2.

04

Landscaping, Dog Park, Lower Nature Trails

- Landscape berm and planting.
- Dog park fencing and trails.
- Lower trails with sections of nature-based play, interpretation and storyboards.
- Site furniture to be purchased as desired/ as funds become available.

Mills & Wright Landscape Architecture
55 Bond Street, Suite 301
St. John's, NL, A1C 1S9

www.millsandwright.ca
(709) 770-5035/8381



**MILLS &
WRIGHT**
LANDSCAPE ARCHITECTURE